

Angie's Musings - Contempo Christmas Stamp Camp

Supplies:

| Description | Item # | Cost |
|-------------------------------------|-----------------------------------|-----------------------|
| Contempo Christmas Stamp Set | #118734 (Wood) or #120594 (Clear) | \$15.95 or \$11.95 |
| Top Note Bigz Die | #113463 | \$21.95 |
| Snow Burst Embossing Folder | #124096 | \$7.95 |
| Ornament Punch | #119847 | \$16.95 |
| Decorative Label Punch | #120907 | \$16.95 |
| Extra Large Oval Punch | #119859 | \$16.95 |
| Modern Label Punch | #119849 | \$16.95 |
| Scallop Square Punch | #119884 | \$16.95 |
| 1 ¼ Square Punch | #124096 | \$15.95 |
| Jolly Holiday Designer Series Paper | | NLA |
| Dimensionals | #104430 (46) | \$3.95 |
| Jewel Rhinestones | #119246 (30 & ½ strip) | \$4.95 |
| Very Vanilla Medium Envelopes | #107300 (8) | \$6.50 |
| Old Olive Satin Ribbon | #117292 | \$8.95 |
| Very Vanilla ½ Ribbon | #109026 | \$4.95 |
| Cherry Cobbler Seam Binding | #124105 (8 inches) | \$6.95 |
| Very Vanilla Cardstock | #101650 (approx 3 Sheets) | \$8.50 |
| Cherry Cobbler Cardstock | #119685 (approx 3 Sheets) | \$6.95 |
| Old Olive Cardstock | #100702 (approx 2 Sheets) | \$6.95 |
| Cherry Cobbler Emboss Powder | #122949 | \$4.75 |

Angie's Musings - Contempo Christmas Stamp Camp

1. *Elf shoes Card* (cased from Valita's Fresh Folds Blog)



| Item | Details |
|---|---|
| Cherry Cobbler cardstock | 8 ½ x 5 ½ |
| Small Dot Designer Series Paper | 5 ¼ x 3 |
| 2 Striped Designer Series Paper | 3 x 7/8 |
| Very Vanilla Cardstock | 5 ¼ x 1 ½ (Trim one side with Scallop Border Punch) & Run Through Snow Burst Embossing Folder |
| Cherry Cobbler cardstock cut with Top Note Bigz Die | See instructions below |
| 2 Very Vanilla BoHo flowers | |
| 12 Dimensionals | Place Behind Shoes & Legs |
| 2 Large Jewels | Place on Flowers and Attach to Toe of Shoes |
| Scallop Square Punch | Cherry Cobbler |
| Stamped Greeting (Holly Jolly) | VersaMark Marker & Cherry Cobbler Embossing Powder |

Angie's Musings - Contempo Christmas Stamp Camp

(Courtesy of <http://valitasfreshfolds.blogspot.com/2010/11/top-note-die-elf-shoes.html>)

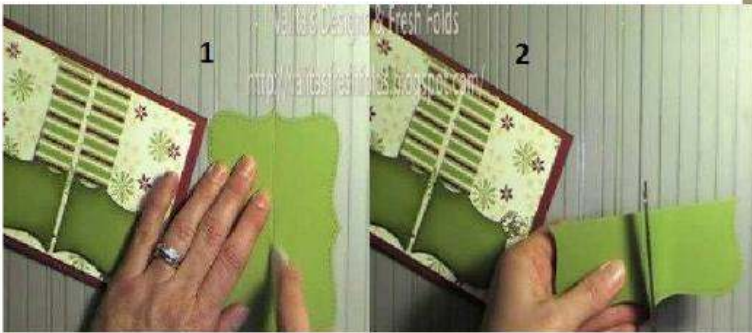

1. Cut a top note die fold down the center length ways
2. Cut in calf the folded top note this will then make two pairs of shoes!



3. punch the legs hole with a 3/4" circle or 1" circle depending on how wide you want the legs to be.
4. At the point of the shoe is where you will line up the large oval for the rest of the shoe shape.



5. after lining up, punch with the large oval to finish the shoe shape
6. Do this to both folded shapes and you'll have both sets of shoes exactly the same as each other.

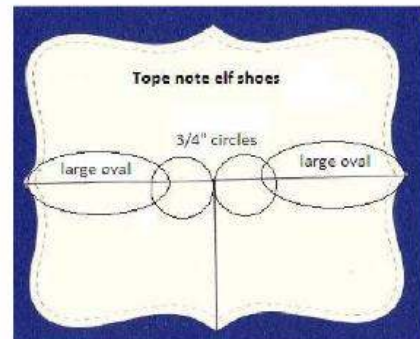

Valita Reynolds 2010 this is not my own creation but is for your private use only.. Unless otherwise stated. All stamped images are COPYRIGHT 2010 Stampin' Upl. Unless otherwise stated. I am an independent demonstrator for Stampin' Upl, and the content of this tutorial is my responsibility. The use of and content or products offered on here may not specifically be endorsed by Stampin' Upl.



7. make 1/2" circle pom poms for the tips of each shoes, add tinsel glitter. cut legs

Angie's Musings - Contempo Christmas Stamp Camp

2. Top Note Card(cased from www.mystampingground.com)



| | |
|---|---------------|
| Old Olive Cardstock | 8 ½ x 5 ½ |
| Designer Series Paper | 5 ¼ x 4 |
| Cherry Cobbler cardstock cut with Top Note Bigz Die | 4 x 5 |
| Sticky Sheet (Mailing Label) | 4 x 5 |
| Very Vanilla Cardstock | 2 x 2 ½ |
| Old Olive Cardstock | 2 1/8 x 2 5/8 |
| Cherry Cobbler Cardstock | 2 ¼ x 2 ¾ |
| Dimensionals | 12 |
| Designer Series Paper Squares | 1 ¼ square |

Angie's Musings - Contempo Christmas Stamp Camp

3. Layered Ornament Card (cased from www.mystampingground.com)



| | |
|--------------------------------------|-------------|
| Cherry Cobbler Cardstock | 8 ½ x 5 ½ |
| Very Vanilla Cardstock | 5 ¼ x 4 |
| Designer Series Paper (top piece) | 5 1/8 x 2 ½ |
| Designer Series Paper (bottom piece) | 5 1/8 x 1 ¾ |
| Ribbon | 6 ½ |

Angie's Musings - Contempo Christmas Stamp Camp

4. Triple Bar Card(cased from www.mystampingground.com)



| | |
|--|---------------|
| Very Vanilla Cardstock | 8 ½ x 5 ½ |
| Cherry Cobbler Cardstock | 5 3/8 x 4 1/8 |
| Designer Series Paper (Inside) | 1 ¾ x 5 ¼ |
| Designer Series Paper (Outside) | 1 x 5 ¼ |
| Very Vanilla Ribbon | |
| Glue to affix bows and dimensionals to attach ornament | 6 |

Angie's Musings - Contempo Christmas Stamp Camp

5. *Bling Tree Card* (cased from www.stampinred.com)



| | |
|--------------------------------|-----------|
| Very Vanilla Cardstock | 8 ½ x 5 ½ |
| Old Olive Cardstock | 5 ¼ x 4 |
| Very Vanilla Cardstock (top) | 5 x 2 |
| Designer Series Paper (bottom) | 5 x 2 ¼ |
| Ribbon | 6 |
| Old Olive Cardstock (tree) | 2 ¼ x 2 ½ |
| Very Vanilla Cardstock (tree) | 2 x 2 ¼ |
| Dimensionals | 4 |

Angie's Musings - Contempo Christmas Stamp Camp

6. *Bling Ornament Card* (cased from www.stampinred.com)



| | |
|--------------------------|-----------|
| Very Vanilla Cardstock | 8 ½ x 5 ½ |
| Cherry Cobbler Cardstock | 5 ¼ x 4 |
| Designer Series Paper | 2 ½ x 3 ¾ |
| Ribbon | 3 inches |
| Very Vanilla Cardstock | 3 ¾ x 5 |

Angie's Musings - Contempo Christmas Stamp Camp

7. *Bling Christmas*



| | |
|--------------------------|------------|
| Cherry Cobbler Cardstock | 8 ½ x 5 ½ |
| Old Olive Cardstock | 5 ¼ x 4 |
| Designer Series Paper | 5 x 3 ¾ |
| Designer Series Paper | ½ Top Note |
| Designer Series Paper | 7/8 x 3 ¾ |
| Dimensionals | 4 |
| Ribbon | 5 inches |

Angie's Musings - Contempo Christmas Stamp Camp

8. Christmas is Joy Side Step Card



| Item | Details |
|--|-----------------------------------|
| Cherry Cobbler Cardstock | 8 ½ x 5 ½ |
| Circle Designer Series Paper (A) | 4 x 1 ¼ |
| Very Vanilla Cardstock (B) | 3 ¼ x ¾ |
| Small Circle Designer Series Paper (C) | 3 ¼ x ¾ |
| Mini Circle Designer Series Paper (D) | 3 ¼ x 3 ¾ |
| Large Circle Designer Series Paper (E) | ½ Top Note |
| 2 Large Jewels | Place on Ornaments |
| 4 Medium Jewels | Adhere to Middle Die Cut |
| 8 Dimensionals | Joy ornament, tree & greeting |
| Cherry Cobbler Embossing Powder | Title, tree, greeting & Ornaments |

Angie's Musings - Contempo Christmas Stamp Camp

